

## Polycrystalline Module Models

SGP-110P-36    SGP-105P-36    SGP-100P-36

## Electrical Specifications

\*STC : Irradiance 1000W/m<sup>2</sup>, AM1.5 spectrum, module temperature 25°C

Model type	GP-110P-36	GP-105P-36	GP-100P-36
Peak power (Pmax)	110W	105W	100W
Cell Efficiency	18.83%	18.52%	17.64%
Maximum power voltage (Vmp)	19.5V	19.2V	18.7V
Maximum power current (Imp)	5.64A	5.47A	5.35A
Open circuit voltage (Voc)	23.0V	22.6V	22.3V
Short circuit current (Isc)	5.97A	5.82A	5.69A
Power Tolerance		±3%	
Maximum system voltage		800V	
Series fuse rating (A)		8	
Number of bypass diode		2	

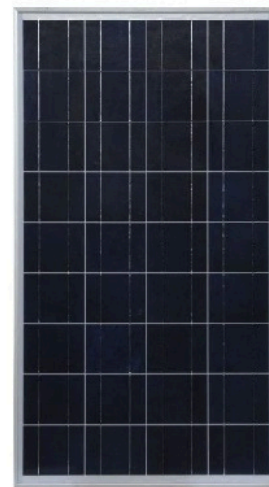

## Temperature Coefficients

Current Temperature Coefficient $\alpha(Isc)$	0.08%/°C
Voltage Temperature Coefficient $\beta(Voc)$	-0.32%/°C
Power Temperature Coefficient	-0.38%/°C
Nominal Temperature Of Cells (NOTC)	46±2°C
Application Temperature Range	-40~+85°C

## Mechanical Characteristics

Dimensions:	1015 x 670 x 30mm (39.96x26.38x1.18 inch)
Weight:	7.2 kg (15.98 lbs)
Solar Cells:	36 cells in series(4 x 9)
Construction:	High-transmission low-iron tempered glass , EVA, TPT/TPE
Frame:	Anodized aluminum is mainly for improving corrosion resistance. Color: silver

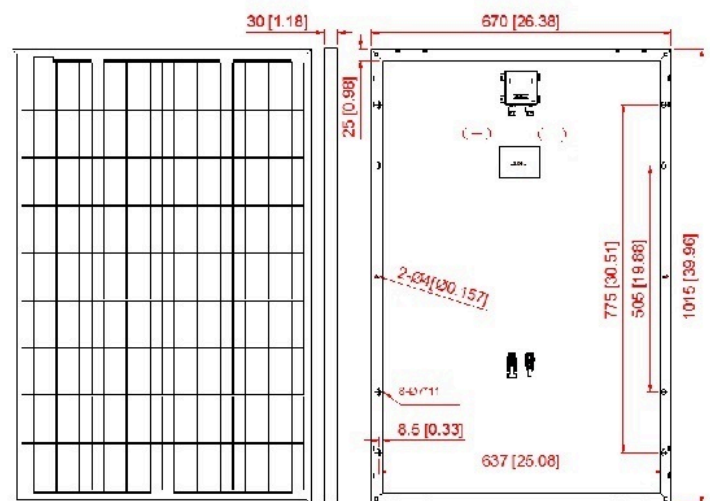

Module Diagram

## Output(Optional)

Cable	LAPP(4 mm <sup>2</sup> )
Lengths	900mm(-) and 900mm(+)
Connector	MC Plug Type IV

## Module Warranty:

25-year limited warranty of 80% power output;

10-year limited warranty of 90% power output;

5-year limited warranty of materials and workmanship.

**Note:** This publication summarizes product warranty and Specifications which are subject to change without notice

Product photos are for reference only, on behalf of actual product.

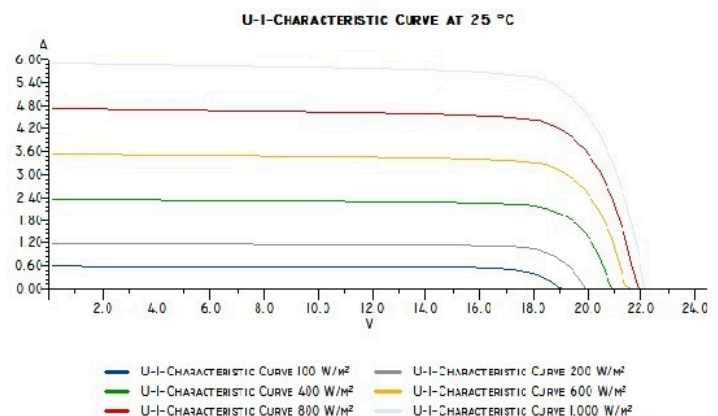

## Electrical Performance